

[spotlight]

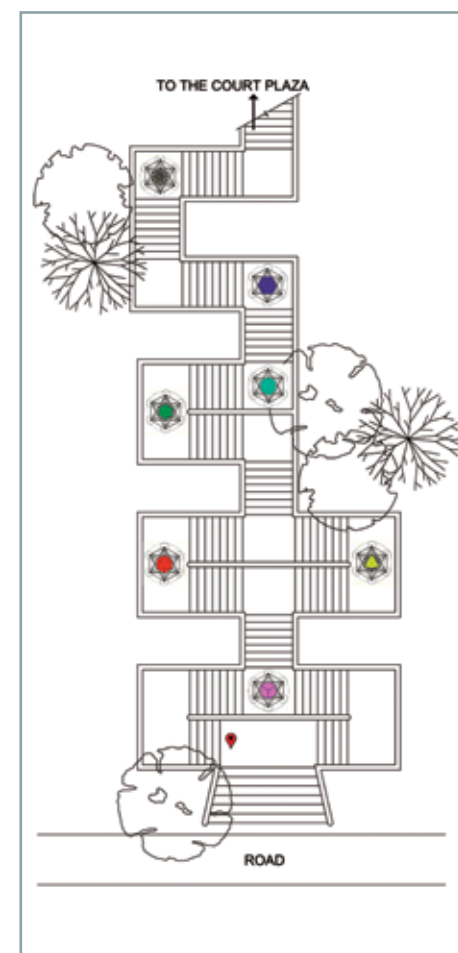
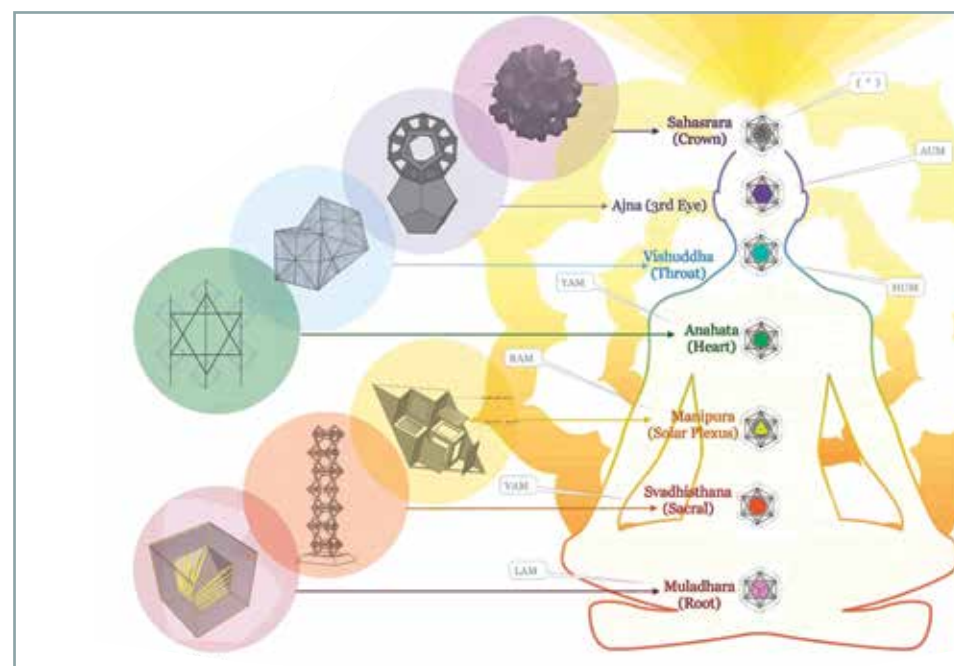

WE ARE BEINGS OF LIGHT

Story of Light, 14-18 January 2015

Located at the cascading staircase leading to the historic Panjim High Court in Goa, this light installation by Arjun Rathi explores the idea of light particles called biophotons, which are emitted by all living things,

and their association with the chakras of a body. The intersection of these chakras and their corresponding geometrical forms, creates a series of seven artistic works represented through definitive solid shapes and colours.

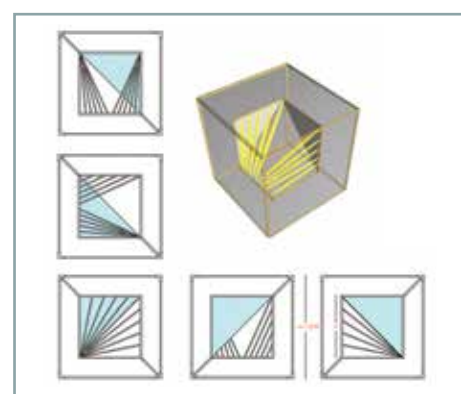

Form 1 - Hexahedron - Root Chakra

The root chakra is located at the base of the spine and represented by the Hexahedron (Cube). The frame is made using acrylic rods and sheets; while the inner cube is composed of 12mm dia. LED tubes, programmed to look as if the cube is rotating.

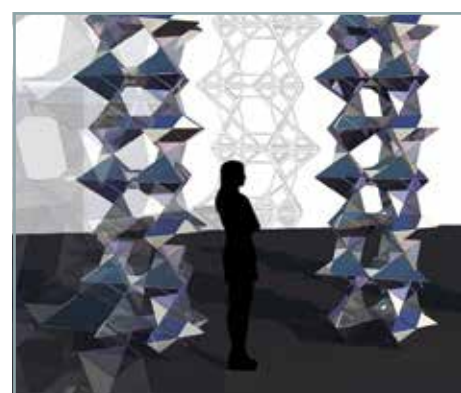

Form 2 - Icosahedron - Sacral Chakra

The sacral chakra is located in the lower abdomen and represented by the Icosahedron (Polyhedron with 20 faces). The installation explores a vertical column structural system made using cast aluminium forms.

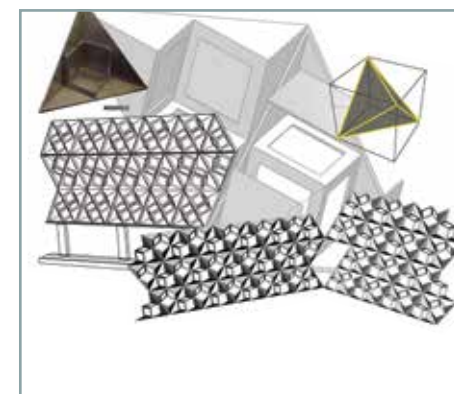

Form 3 - Tetrahedron - Solar Plexus Chakra

The solar plexus chakra located in the stomach is represented by the Tetrahedron. The modular form created using cast aluminium modules was a prototype for a media façade or free standing screens inspired by the form.

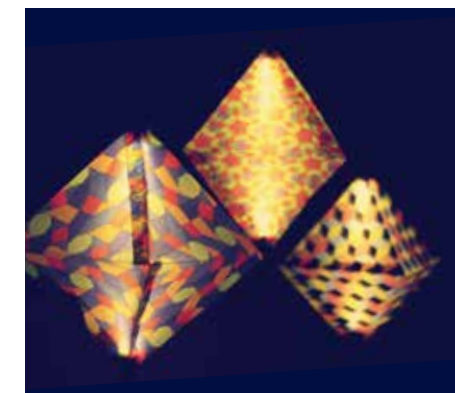
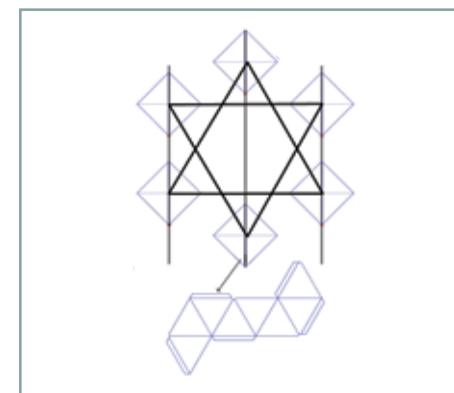

Form 4 - Star Tetrahedron - Heart Chakra

The fourth chakra is located in the heart and represented by the Star Tetrahedron. The installation explores sacred geometrical patterns and diagrams, which were printed on translucent paper to create lanterns.



Form 5 - Octahedron - Throat Chakra

The fifth chakra is located in the throat and is represented by the Octahedron. This shape fits perfectly into the Dodecahedron, which was used to create the installation. The shapes made using PU sheets were lit internally with micro halogen bulbs.

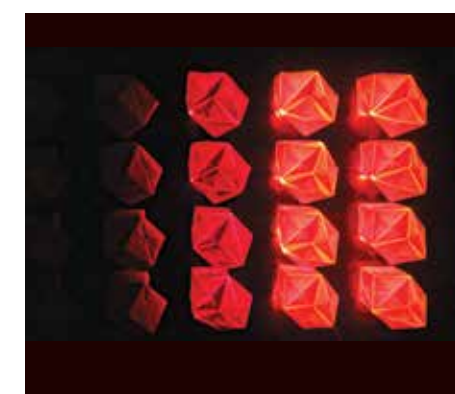
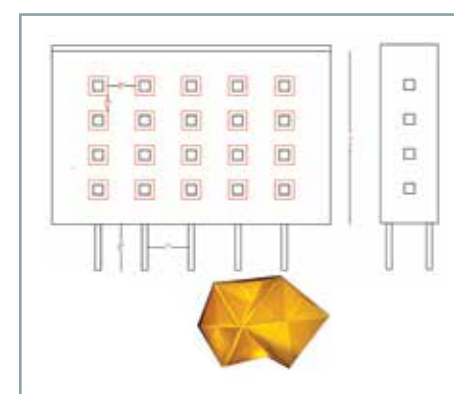

Form 6 - Dodecahedron - Third Eye Chakra

The sixth chakra located in the middle of the forehead is represented by the Dodecahedron. In Sacred Geometry, the Vesica Piscis diagram is used for the Third Eye. A 3-dimensional diagram was derived using platonic solids to make the form.

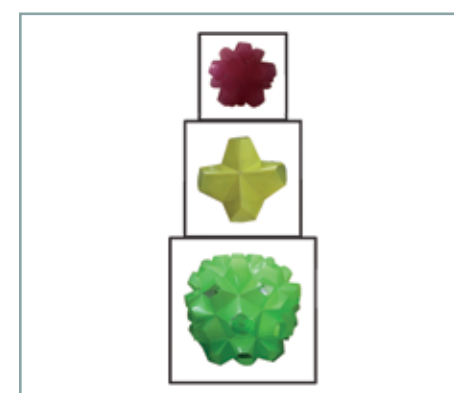

Form 7 - Sphere - Crown Chakra

The seventh chakra located at the top of the head is represented by the Sphere. The chakra is responsible for creating the energy 'sphere' around the body; hence we see derivations of the spherical shape, inspired by the origami "Turtle" unit. Forms of 12, 30 and 120 Turtle units were used to create a perfect sphere, on which sacred geometrical diagrams were projected.